

**KIT PART NUMBER 3272023 & 3272024**  
**INSTRUCTIONS FOR INSTALLING A BACKLIT DISPLAY KIT**

**CHECK THE PARTS RECEIVED IN THE KIT WITH THE PARTS LIST IN THESE INSTRUCTIONS. IF ANY PARTS ARE MISSING, CONTACT THE CRANE MERCHANDISING SYSTEMS PARTS DEPARTMENT IMMEDIATELY.**

**Read these instructions carefully before installing the kit.  
 Keep these instructions for part numbers and for future reference.**

**KIT USAGE**

KIT PART NUMBER	VOLTAGE/MODEL NUMBER/CLASSIFICATION
3272023	110V, 327 & 328 BACKLIT - DOMESTIC
3272024	230V, 327 & 328 BACKLIT - INTERNATIONAL

**THIS KIT CONTAINS THE FOLLOWING**

PART NUMBER	DESCRIPTION	QTY PER KIT	
		3272023	3272024
3272025	KIT INSTR. FOR INSTLG. A BKLIT. DISPLAY	1	1
3272002	MOUNT ASSEMBLY, LOWER	1	1
3272005	LIGHT BRACKET ASSY.-BACKLIT P.O.P.	1	1
6532017	INSULATION DISC	1	1
P3272008	BALLAST ASSEMBLY	1	
P3272018	BALLAST ASSEMBLY, FOREIGN		1
P3272009	BACKLIGHT ASSEMBLY	1	1
3272022	KIT DISPLAY PANEL ASSEMBLY	1	1
3632049	LABEL, INSTR.-COLD DRINKS, ENGL.	1	1
3632052	LABEL, INSTR.-COLD DRINKS, FRENCH	1	1
3632096	LABEL, INSTR.-COLD DRINKS, GER.	1	1
6532018	RETAINER, DISPLAY	1	1
3272012	P.O.P. BACKLIT, COLD DRINK CENTER	1	1
3272013	FRAME, DISPLAY, P.O.P.	1	1
3272015	COVER, BALLAST & HARNESS	1	1
3272020	RETAINER, TOP, P.O.P.	1	1
3272021	RETAINER, BOTTOM, P.O.P.	1	1
1679005	FLST. LIGHT FILTER-120/230V	1	1
4559009	HARNESS, JUMPER	1	1
3279002	HARNESS, BACKLIGHT, CDC	1	1
1451097	SCREW, #8-32 X .31 LG. (SHORT BLACK)	4	4
4741050	SCREW, #8-32 X .50 LG. (LONG BLACK)	8	8
2222031	TEE BOLT - TRIM	1	1
1572242	SCREW, #8-18 X .75 LG. PLASTITE HHS	1	1

---

## Overview of the modification:

The modification kit is being offered to add a backlit P.O.P. display to the machine.

### Part I. Prepare the machine:

1. Turn off the power switch and unplug the machine from its power source.

### Part II. Remove the following components (see figure 1) and retain:

1. Remove the two cup mech.and canister assemblies by loosening the four mounting bolts on each, unplugging the harnesses and removing the screws that attach the tilt straps to the upper light bracket. Remove the cup mech. mounting bracket closest to the hinge side of the door by removing the two mounting bolts. Remove the center cup mech. mounting bracket by removing the three mounting bolts.
2. Remove the display panel assembly by removing the three thumbscrews from the side of the display panel.

#### **CAUTION**

*After completing steps 3 thru 5 caution should be used as the door glass is retained only on the one side. Do not press on the glass from the front of the door.*

3. Remove the display mount bracket from the hinge side of the door by removing four screws. Discard the display mount bracket
4. Remove the lower display panel mount assembly by removing four screws. Discard the lower display panel mount.
5. Unplug and remove the upper light bracket assembly. On international machines remove the wire and ballast guards. Remove the upper light ballast.

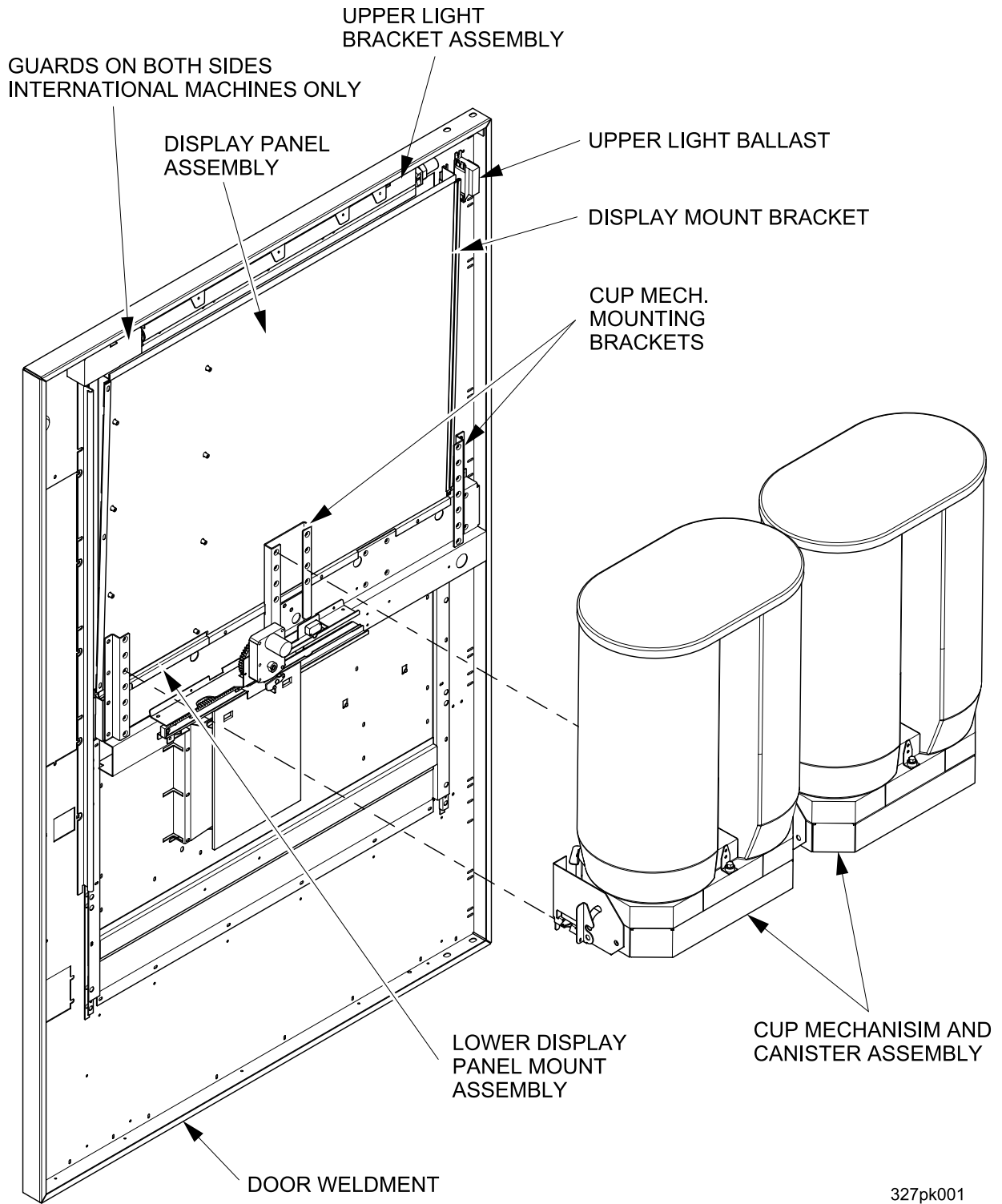
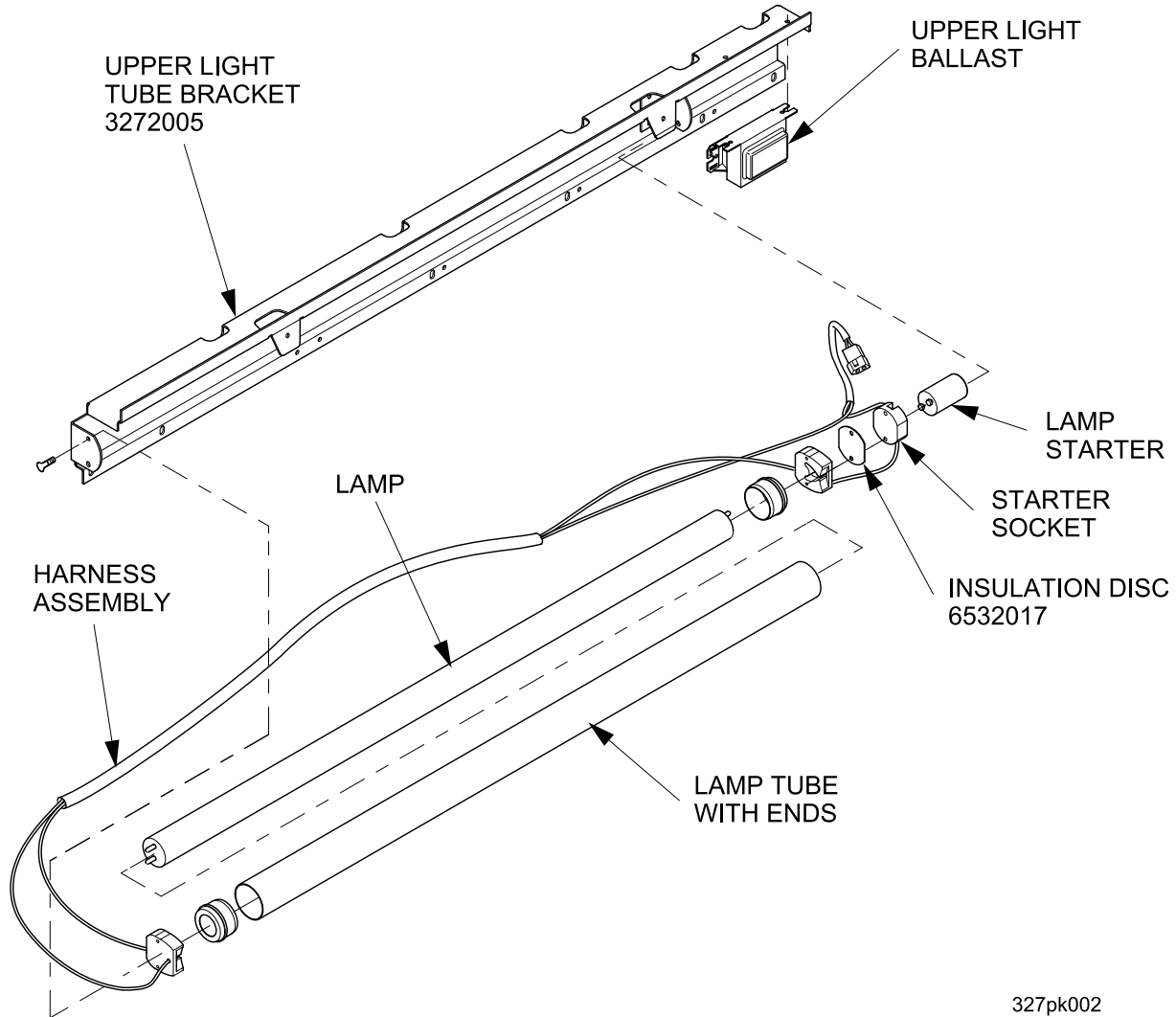

Figure 1

---

**Part III. Sub-Assemble the following components:**

1. Disassemble the upper light assembly and reassemble the removed components on the new upper light tube bracket (3272005) making sure to place the insulation disc (6532017) under the starter socket for grounding protection. Assemble the upper light ballast to the new upper light tube bracket using two short black screws (see figure 2). Discard the old upper light bracket.



**Figure 2**

327pk002

- 
2. Attach the appropriate language cold drink label (36320xx) to the front of the display panel assembly (3272022) as shown (see figure 3) (use the old display panel as a guide for locating the label). Move all of the product selection inserts from the old display panel to the new display panel. Discard the old display panel.

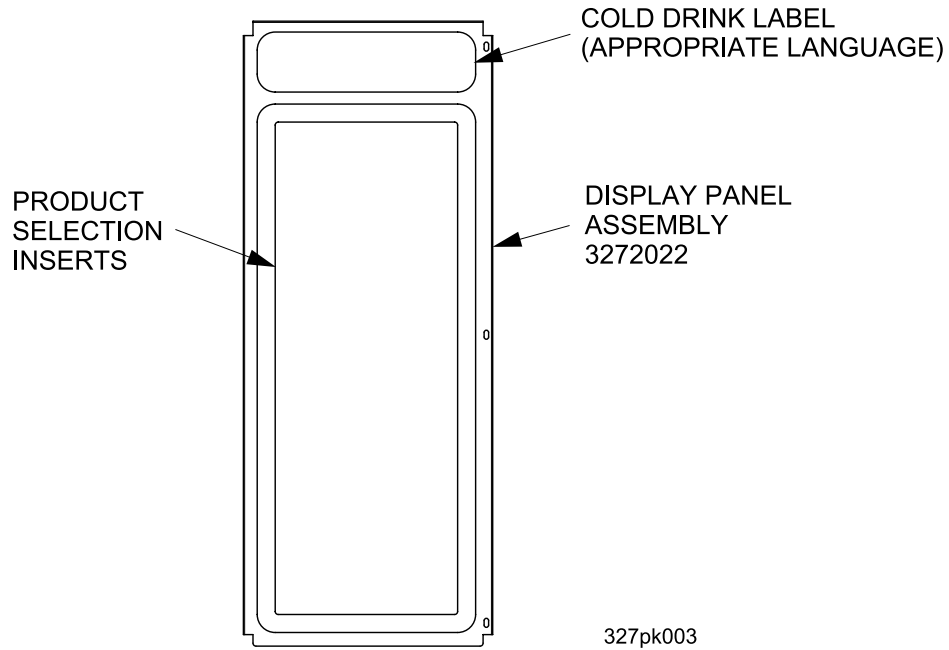
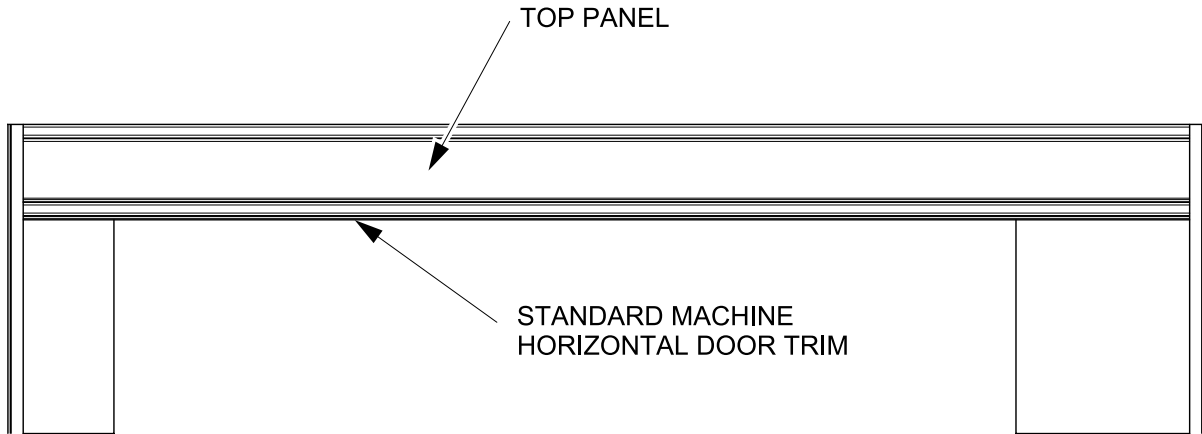

**Figure 3**

- On standard styling machines the horizontal door trim needs to be removed (if the top panel slides down temporarily tape it up) and the tee bolts repositioned with 1 short tee bolt removed and 1 long tee bolt (2222031) added. Reinstall the horizontal door trim with tee bolts as shown (see figure 4).

**NOTE**

*Holes used for Millennia styling are also noted in figure 4. One extra screw (1572242) will be needed.*



327pk004

**CALLOUTS ABOVE VIEW FOR STANDARD DOOR STYLING**

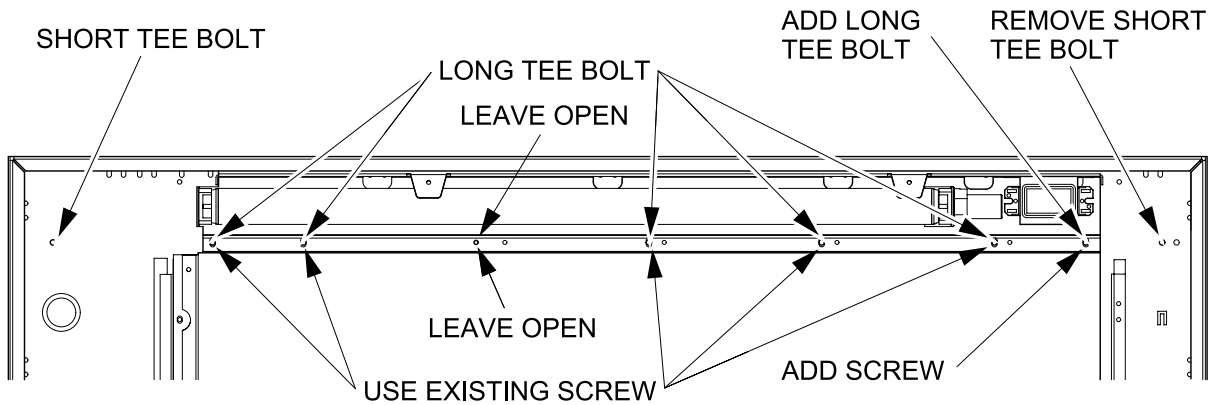

**CALLOUTS BELOW VIEW FOR MILLENNIA DOOR STYLING**

327pk005

**Figure 4**

#### Part IV. Installing the Backlit Display Kit (see figure 5):

1. Install the upper light assembly (sub-assembled in part III) using existing hardware. Use figure 4 as a guide for locating tee bolts of the standard style machines and screws on the Millennium style machines.
2. Loosely install the lower mount assembly (3272002) using four existing short black screws.
3. Position the P.O.P. display frame (3272013) capturing the lower flange in front of the lower mount assembly installed in step 2 and install the display retainer (6532018) using two short black screws.
4. Bend the tang that mounted the bottom of the upper light ballast flat to the door and install the ballast assembly (P3272008 or P3272018) using the two middle mounting holes only by screwing through the slots in the P.O.P. display frame and into the door weldment with two long black screws.
5. Position the backlit P.O.P. (3272012) and retain by installing the top P.O.P. retainer (3272020) using four existing short black screws and bottom P.O.P. retainer (3272021) under three screws used to attach the lower mount assembly. Tighten the lower mount assembly screws.

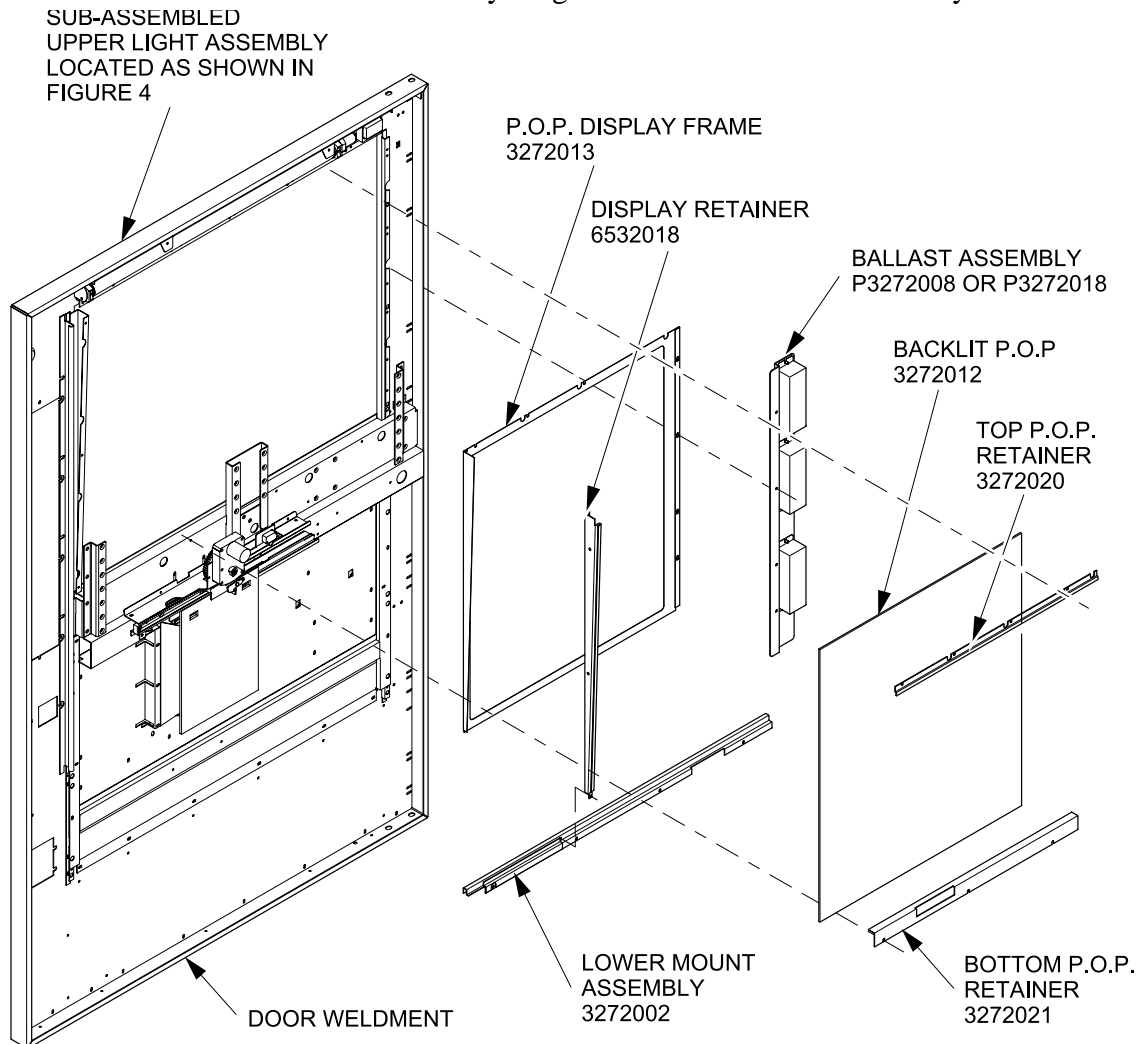

327pk006

Figure 5

6. Install the new display panel assembly (sub-assembled in part III) using three existing thumb-screws. (see figure 6)

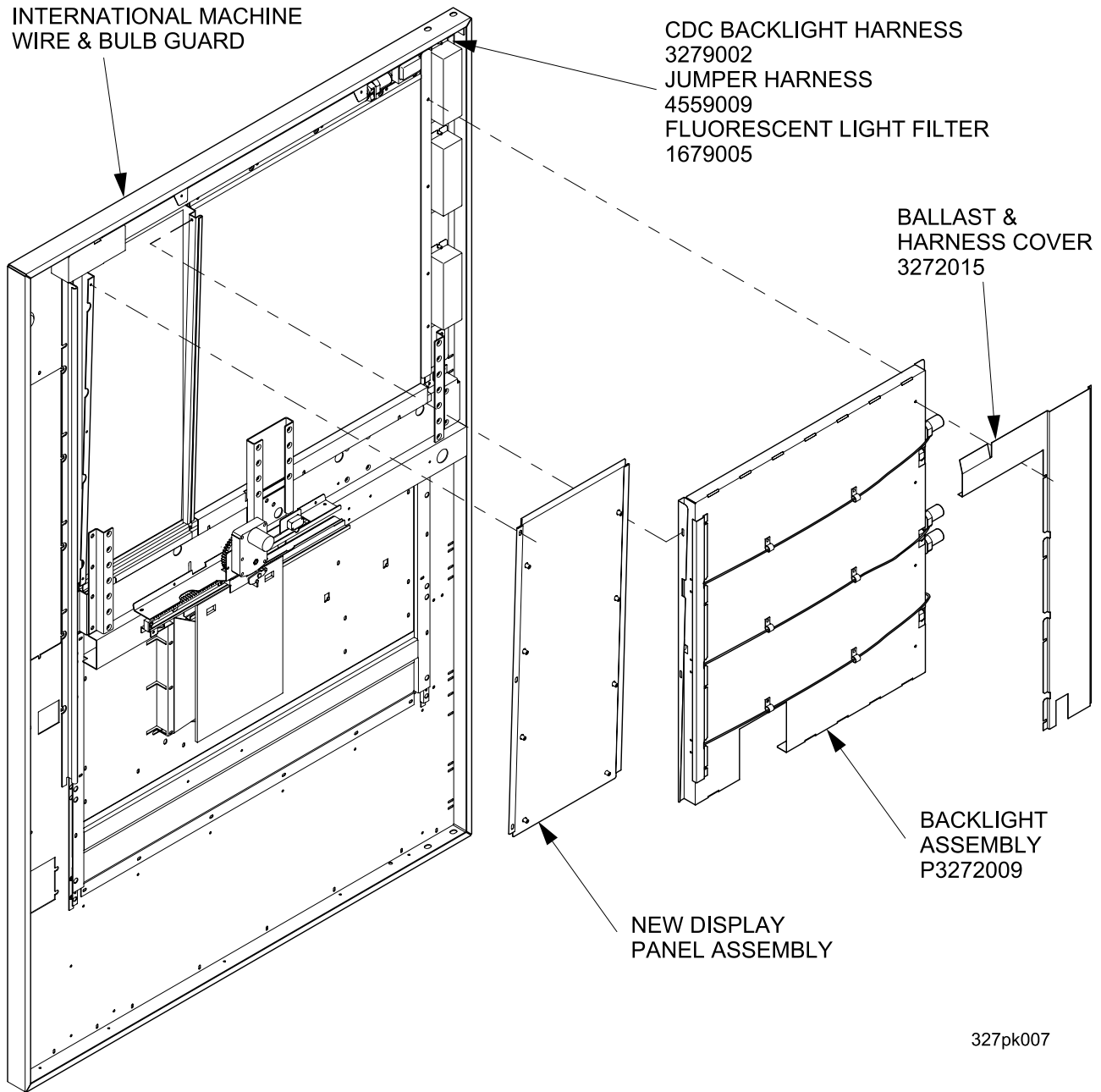

**Figure 6**

7. Install the backlight assembly (P3272009) by inserting onto pins in the display retainer and using two long black screws through the ballast assembly and into the door weldment.
8. Install the CDC backlight harness (3279002) to the three lamp harnesses and to the three ballasts with the end connector at the top.
9. Install the jumper harness (4559009) to the end of the door harness. Install the fluorescent light filter (1679005) to one end of the jumper harness and then to the backlight harness. Connect the other end of the jumper harness to the new upper light assembly. Reconnect the upper fluorescent light harness to the ballast and dress the wires inside the door flanges.



- 
10. Temporarily plug the machine into the power source and turn on the power switch. Check that all bulbs light up. Turn off the power switch and unplug the machine.

**WARNING**

*Failure to disconnect machine from electrical supply could result in a shock hazard.*

11. Install the ballast & harness cover (3272015) using four short black screws.
12. On international machines replace the wire and bulb end guard on the left side of the upper light assembly.

**Part V. Reassemble (see figure 1):**

1. Replace the center cup mech. mounting bracket by replacing the three mounting bolts removed in part II. Replace the cup mech. mounting bracket closest to the hinge side of the door by replacing the two bolts removed in part II. Replace the two cup mech. and canister assemblies removed in part II, on to the four mounting bolts for each and tighten the four bolts on each. Replace the tilt straps using existing screws. Plug in the cup mech. harnesses.

**Part VI. Return the machine to service:**

1. Restore power to the machine.
2. The modification procedure is complete.